

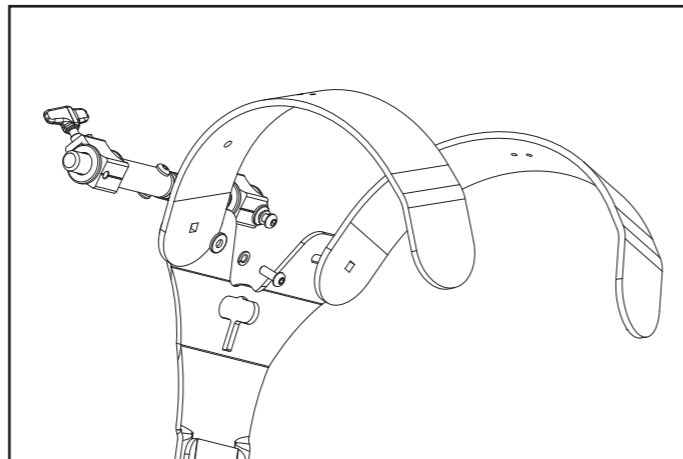

MVBD-MPN marching bass drum carrier

ASSEMBLY INSTRUCTION

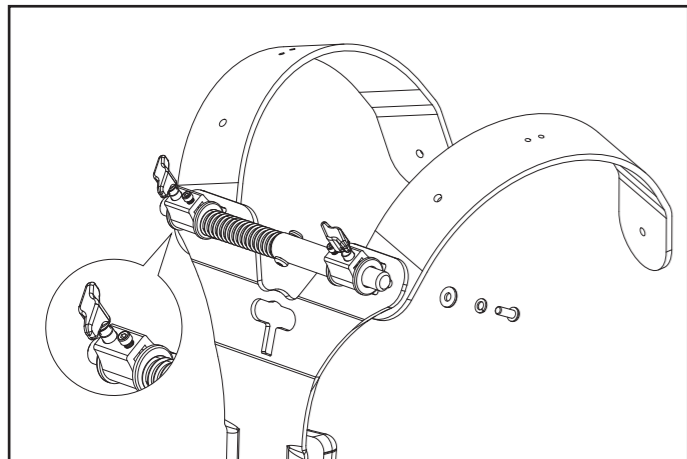

Step 1:
Fasten the bass drum attachment to the chest and shoulder plates in the above order.

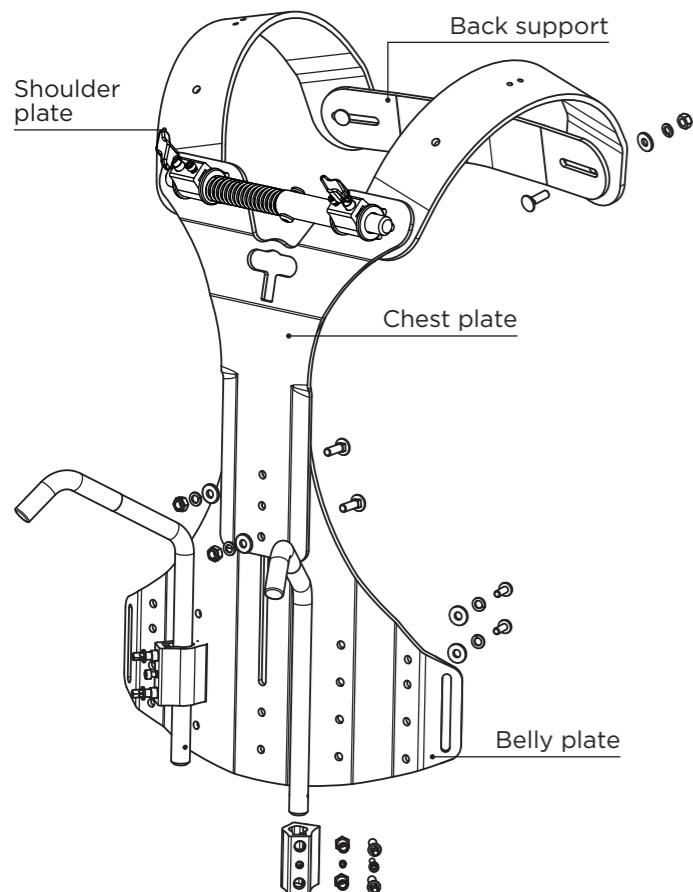

Step 2:
Fasten the belly plate to the chest plate (J-Hook fixers should be already attached to the belly plate).

Step 3:
Fasten back support plates to shoulder plates.

Step 4:
Adjust width and angle of shoulder plates to fit comfortably.

Step 5:
Adjust belly plate to suitable position.

Step 6:
Add belt (if required) & padding to the belly, shoulder and back support plate. The carrier is now ready for use.

How to use the bass drum attachment:

Compress the spring to shorten the length of the attachment and insert one end into one of the bass drum eye-bolts. Relax the spring to return the attachment to its natural extended length, and allow the remaining end to slide into the unoccupied eye-bolt. Tighten the wing nut for additional security.

For further information, please refer to the official MAPEX website.



MAPEX Marching Vest Carriers

Assembly Manual



MVSD-MPN marching snare drum carrier

ASSEMBLY INSTRUCTION

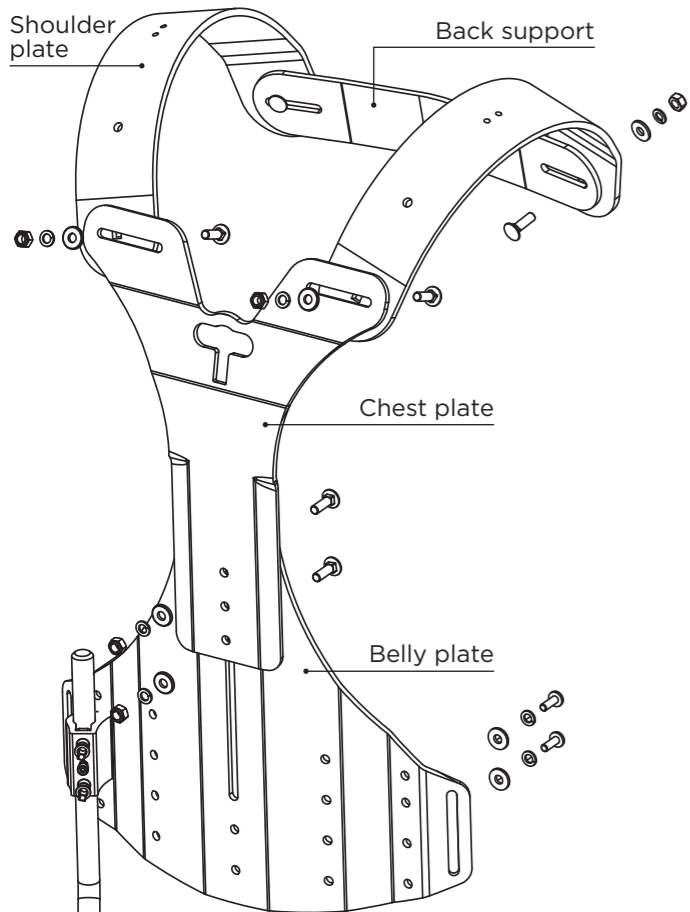

- Step 1:**
Fasten the chest plate to shoulder plates.
- Step 2:**
Fasten the belly plate to the chest plate (J-Hook fixers should be already attached to the belly plate).
- Step 3:**
Fasten back support plates to shoulder plates.
- Step 4:**
Adjust width and angle of shoulder plates to fit comfortably.
- Step 5:**
Adjust belly plate to suitable position.
- Step 6:**
Add belt (if required) & padding to the belly, shoulder and back support plate. The carrier is now ready for use.

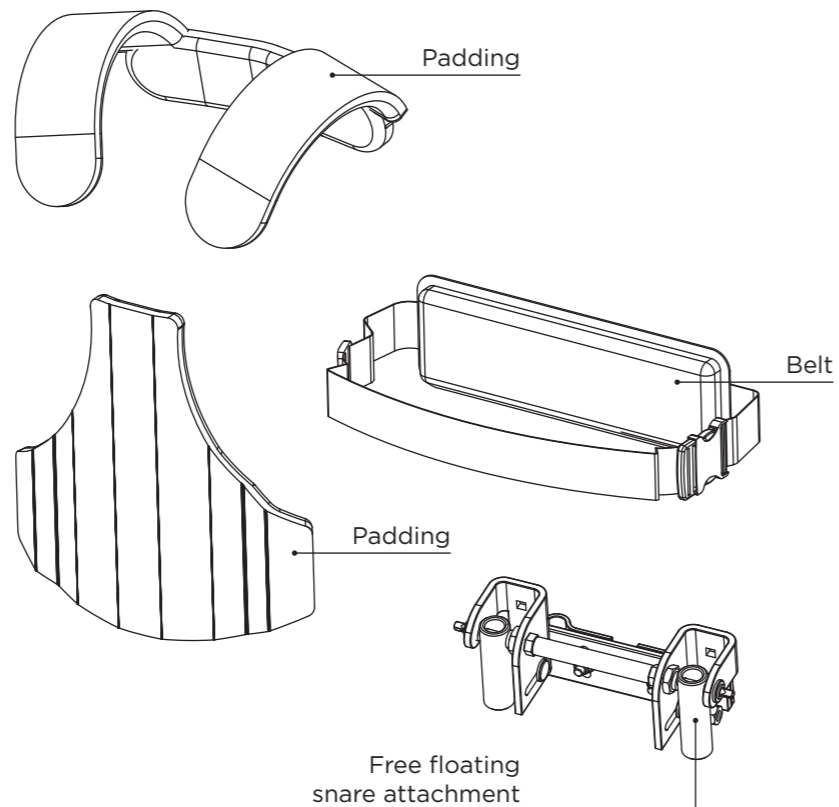

MVQD-MPN marching tenor drum carrier

ASSEMBLY INSTRUCTION

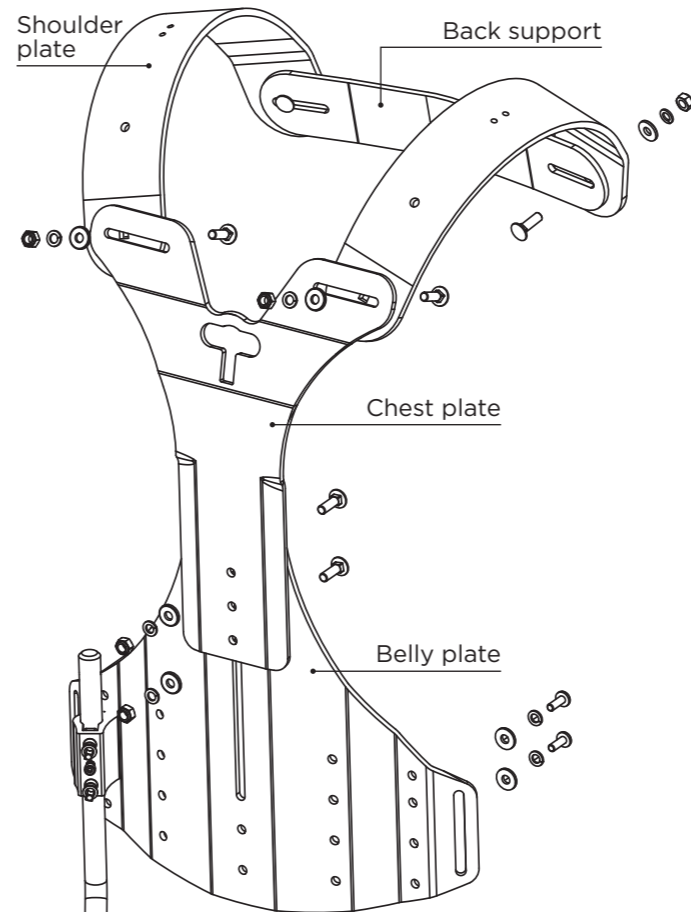

- Step 1:**
Fasten the chest plate to shoulder plates.
- Step 2:**
Fasten the belly plate to the chest plate (J-Hook fixers should be already attached to the belly plate).
- Step 3:**
Fasten back support plates to shoulder plates.
- Step 4:**
Adjust width and angle of shoulder plates to fit comfortably.
- Step 5:**
Adjust belly plate to suitable position.
- Step 6:**
Add belt (if required) & padding to the belly, shoulder and back support plate. The carrier is now ready for use.

